

\$192,500 - 260 Greenwich Lane, Fort McMurray

MLS® #A2202979

\$192,500

2 Bedroom, 1.00 Bathroom, 1,306 sqft
Residential on 0.10 Acres

Gregoire Park, Fort McMurray, Alberta

Welcome to 260 Greenwich Lane! This beautifully renovated mobile home is move-in ready and perfectly situated near schools, parks and amenities. The owners have spared no expense in updating this home—major upgrades in the last three years include a new furnace, air conditioning system, shingles and more! Inside, you'll find a stunning new kitchen, modern vinyl plank flooring, fresh paint and a gas fireplace, creating a warm and inviting space. This unique floor plan offers ample space, including a dedicated mudroom entrance, a versatile addition that can serve as a dining area, playroom, or music room and a flexible extra room—perfect for guests, storage or a home-based business. Outside, enjoy ample off-street parking, a front porch and a spacious rear deck. The backyard also features a large shed with a convenient roll-up garage-style door. ** ECONOMIC LIFE REPORT COMPLETED IN FEBRUARY 2025 - NEW EFFECTIVE AGE OF 20 YEARS (2005) **

Built in 1977

Essential Information

MLS® #	A2202979
Price	\$192,500
Bedrooms	2
Bathrooms	1.00
Full Baths	1

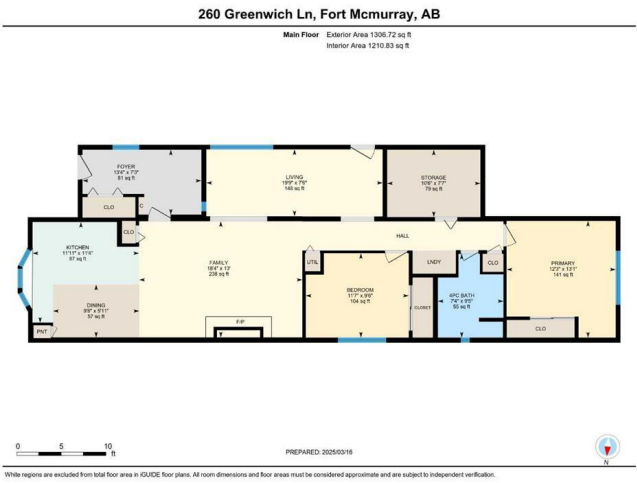

Square Footage	1,306
Acres	0.10
Year Built	1977
Type	Residential
Sub-Type	Detached
Style	Single Wide Mobile Home
Status	Active

Community Information

Address	260 Greenwich Lane
Subdivision	Gregoire Park
City	Fort McMurray
County	Wood Buffalo
Province	Alberta
Postal Code	T9H3Z3

Amenities

Amenities	Park, Visitor Parking
Parking Spaces	3
Parking	Driveway, Off Street

Interior

Interior Features	Jetted Tub, No Animal Home, Open Floorplan, Storage, Vinyl Windows
Appliances	Central Air Conditioner, Dishwasher, Electric Stove, Microwave, Refrigerator, Washer/Dryer, Window Coverings
Heating	Fireplace(s), Forced Air, Natural Gas
Cooling	Central Air
Fireplace	Yes
# of Fireplaces	1
Fireplaces	Gas
Basement	None

Exterior

Exterior Features	Lighting
Lot Description	Back Yard, City Lot
Roof	Asphalt Shingle
Construction	Mixed, Other, Vinyl Siding, Wood Frame
Foundation	Piling(s)

Additional Information

Date Listed	March 17th, 2025
Days on Market	32
Zoning	RMH-2

Listing Details

Listing Office	COLDWELL BANKER UNITED
----------------	------------------------

Data is supplied by Pillar 9â„¢ MLS® System. Pillar 9â„¢ is the owner of the copyright in its MLS® System. Data is deemed reliable but is not guaranteed accurate by Pillar 9â„¢. The trademarks MLS®, Multiple Listing Service® and the associated logos are owned by The Canadian Real Estate Association (CREA) and identify the quality of services provided by real estate professionals who are members of CREA. Used under license.